



Inorax-ST Network Cabinet

Inorax-ST, a cost effective network rack cabinet system fulfills high density cabling and data center requirements. With its modular structure, a practical option for your future plans. Offers advanced fiber and copper cable management options; helps simplify cable installation and maintenance while providing maximum cable capacity for your high-density cabling requirements. A wide range of cable management accessories is available to ensure perfect management of copper, fiber cables and 19" equipment. Flat-pack option enables savings up to 60% in the transport cost and warehouse space.

Technical Features

Material	1-1,2-1,5-2mm Steel
Color	RAL 7035 or RAL 9005
Compliance	RoHS, UL Certified
Packaging	Assembled or unassembled
Maximum Static Load	Up to 1500 kg.
Finish	Doors, side panels, top and bottom covers Electrostatic Powder Paint, 19" mounting rails: Zinc-plated

Standard Configuration:

- Front door with safety glass
- Solid Side Panels with cylindrical locks and latches
- Solid Rear Panel with cylindrical locks
- Internal top sheet with 3 cable entries for 800 width,
1 cable entry for 600 width racks and fan cut-outs
- 2 Pairs of depth adjustable heavy duty 19" Mounting Rails
- 2 Pairs of Adjustable Feet
- Front Door with swing-handle single point lock
- Bottom cover with 3 cable entries for 800 width,
1 cable entry for 600 width racks

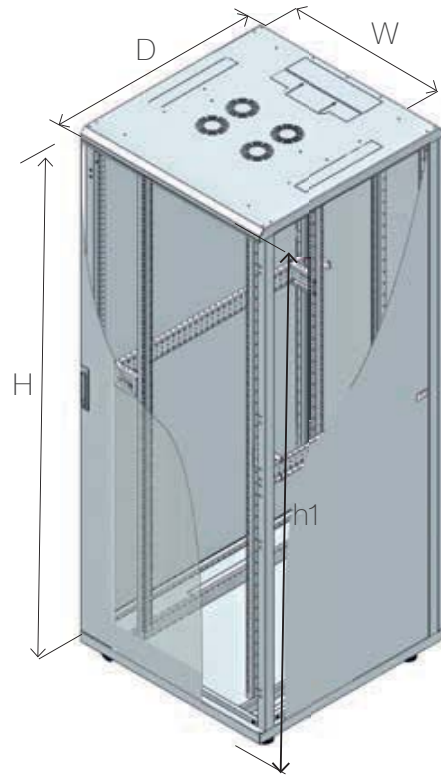
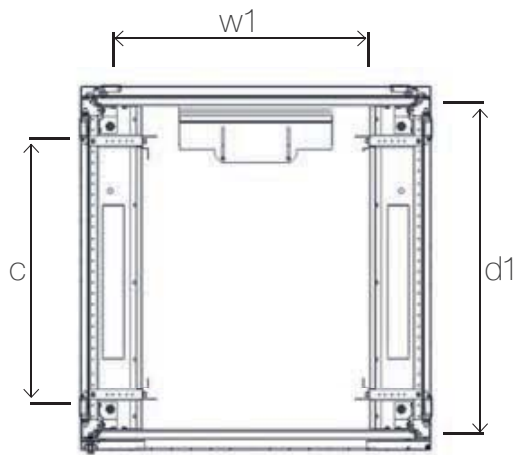

Order Information

Height U	Outer Width (w) mm	Outer Depth (D) mm	Outer Height (H) mm	Inner Width (w1) mm	Inner Depth (d1) mm	Inner Height (h1) mm	19" Rails Adjustable Depth Range (c)	Weight kg	Part No
16U	600	600	878	503	550	718	123 - 373	52,8	CSN-X-1666A
22U	600	600	1144	503	550	984	123 - 373	62,2	CSN-X-2266A
22U	600	800	1144	503	750	984	123 - 573	70,7	CSN-X-2268A
26U	600	600	1322	503	550	1162	123 - 373	68,5	CSN-X-2666A
26U	600	800	1322	503	750	1162	123 - 573	77,6	CSN-X-2668A
26U	800	800	1322	703	750	1162	123 - 573	91,6	CSN-X-2688A
32U	600	600	1588	503	550	1428	123 - 373	77,9	CSN-X-3266A
32U	600	800	1588	503	750	1428	123 - 573	88,0	CSN-X-3268A
32U	800	800	1588	703	750	1428	123 - 573	103,2	CSN-X-3288A
36U	600	600	1766	503	550	1607	123 - 373	84,2	CSN-X-3666A
36U	600	800	1766	503	750	1607	123 - 573	95,0	CSN-X-3668A
36U	800	800	1766	703	750	1607	123 - 573	110,0	CSN-X-3688A
39U	800	800	1900	703	750	1740	123 - 573	115,5	CSN-X-3988A
42U	600	600	2033	503	550	1873	123 - 373	93,6	CSN-X-4266A
42U	600	800	2033	503	750	1873	123 - 573	105,4	CSN-X-4268A
42U	600	1000	2033	503	950	1873	123 - 773	113,9	CSN-X-4260A
42U	800	800	2033	703	750	1873	123 - 573	121,3	CSN-X-4288A
42U	800	1000	2033	703	950	1873	123 - 773	133,5	CSN-X-4280A
47U	600	600	2255	503	550	2095	123 - 373	101,5	CSN-X-4766A
47U	600	800	2255	503	750	2095	123 - 573	114,0	CSN-X-4768A
47U	600	1000	2255	503	950	2095	123 - 773	123,2	CSN-X-4760A
47U	800	800	2255	703	750	2095	123 - 573	131,0	CSN-X-4788A
47U	800	1000	2255	703	950	2095	123 - 773	144,0	CSN-X-4780A

X (Color code): 7:RAL 7035 Light Grey, 9:RAL 9005 Black

Components of inorax-ST

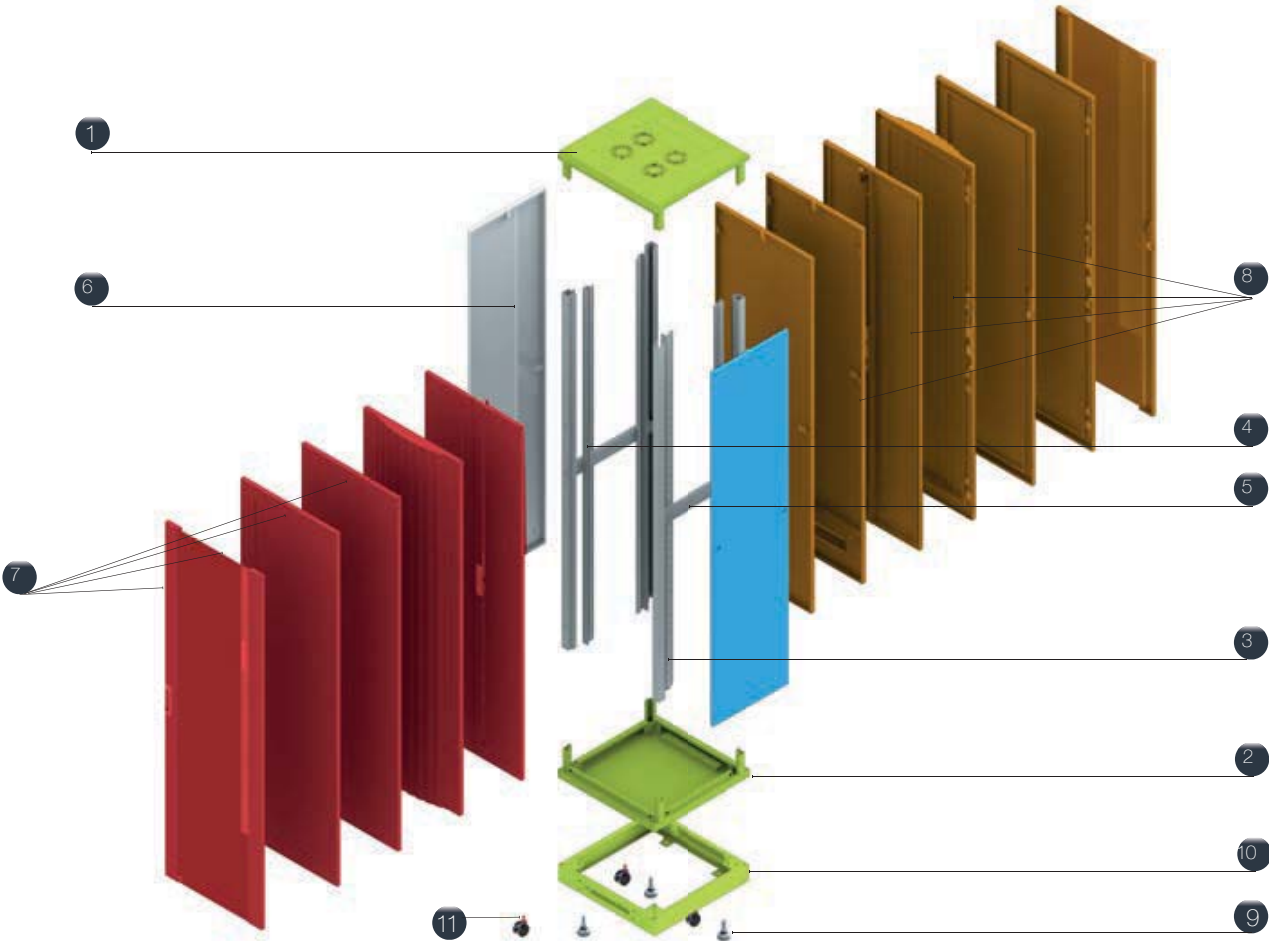

- 1- Top Cover
- 2 - Bottom Cover
- 3 - Vertical Profiles
- 4 - 19" Mounting Rails
- 5 - Side Support Rails
- 6 - Side Panel
- 7 - Front Door Options
- 8 - Rear Door Options

- 9 - Adjustable Feet
- 10 - Plinth
- 11 - Castor



Page : 102



Page : 103

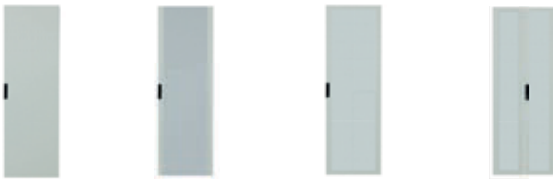

Page : 104



Page : 105



Page : 106 - 107

Components of inorax-ST

Top Cover

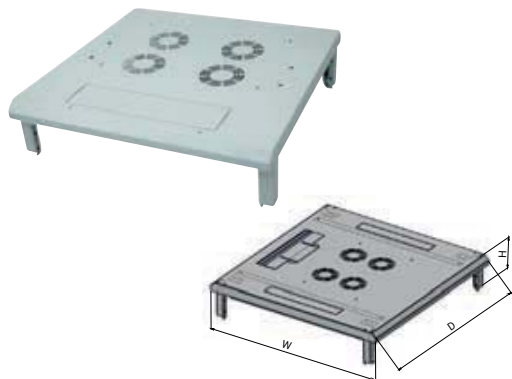

Material	1.5 mm Steel	Finish	Electrostatic Powder Paint
Color	RAL 7035 (Light Grey) and RAL 9005 (Black)		

W (mm)	D (mm)	H (mm)	Weight kg	Part No
600	600	154	10,8	CSZ-X-YY660-0401
600	800	154	12,7	CSZ-X-YY680-0401
600	1000	154	14,6	CSZ-X-YY600-0401
600	1100	154	15,5	CSZ-X-YY610-0401
600	1200	154	16,4	CSZ-X-YY620-0401
800	800	154	16,7	CSZ-X-YY880-0401
800	1000	154	19,6	CSZ-X-YY800-0401
800	1100	154	21,0	CSZ-X-YY810-0401
800	1200	154	22,4	CSZ-X-YY820-0401

Bottom Cover



Material	1.5 mm Steel	Finish	Electrostatic Powder Paint
Color	RAL 7035 (Light Grey) and RAL 9005 (Black)		

W (mm)	D (mm)	H (mm)	Weight kg	Part No
600	600	154	11,1	CSZ-X-YY660-0403
600	800	154	13,0	CSZ-X-YY680-0403
600	1000	154	15,0	CSZ-X-YY600-0403
600	1100	154	15,9	CSZ-X-YY610-0403
600	1200	154	16,9	CSZ-X-YY620-0403
800	800	154	17,2	CSZ-X-YY880-0403
800	1000	154	20,0	CSZ-X-YY800-0403
800	1100	154	21,5	CSZ-X-YY810-0403
800	1200	154	22,9	CSZ-X-YY820-0403

Vertical Profiles

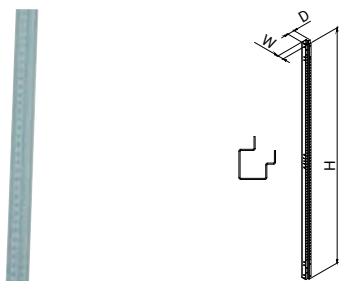

Material	1.5 mm Steel	Finish	Electrostatic Powder Paint
Color	RAL 7035 (Light Grey) and RAL 9005 (Black)		

H (U)	W (mm)	D (mm)	H (mm)	Weight kg	Part No
16U	48,5	57	754	1,4	CSZ-X-16YY0-0300
22U	48,5	57	1021	1,8	CSZ-X-22YY0-0300
26U	48,5	57	1199	2,2	CSZ-X-26YY0-0300
32U	48,5	57	1465	2,6	CSZ-X-32YY0-0300
36U	48,5	57	1643	2,9	CSZ-X-36YY0-0300
39U	48,5	57	1777	3,2	CSZ-X-39YY0-0300
42U	48,5	57	1910	3,5	CSZ-X-42YY0-0300
47U	48,5	57	2132	3,8	CSZ-X-47YY0-0300

19" Mounting Rails

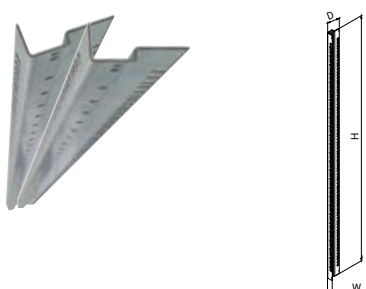

Material	2 mm Steel	Finish	Zinc-Plated
-----------------	------------	---------------	-------------

H (U)	W (mm)	D (mm)	H (mm)	Weight kg	Part No
16U	33	52	753	1,0	CSZ-0-16YY0-0600
22U	33	52	1020	1,3	CSZ-0-22YY0-0600
26U	33	52	1198	1,5	CSZ-0-26YY0-0600
32U	33	52	1464	1,8	CSZ-0-32YY0-0600
36U	33	52	1642	2,0	CSZ-0-36YY0-0600
39U	33	52	1776	2,2	CSZ-0-39YY0-0600
42U	33	52	1909	2,4	CSZ-0-42YY0-0600
47U	33	52	2131	2,7	CSZ-0-47YY0-0600

X : Color code = 7: RAL 7035 (Grey); 9: RAL 9005 (Black)

Side Support Rails

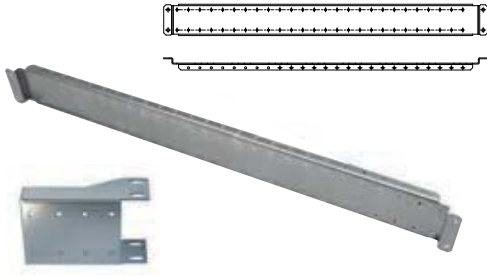

Material	2 mm Steel	Finish	Zinc-Plated
Cabinet W (mm)	Cabinet D (mm)	Weight kg	Part No
600	600	0,7	CSZ-0-YY660-0700
600	800	0,8	CSZ-0-YY680-0700
600	1000	0,8	CSZ-0-YY600-0700
600	1100	0,9	CSZ-0-YY610-0700
600	1200	0,9	CSZ-0-YY620-0700
800	800	0,8	CSZ-0-YY880-0700
800	1000	0,9	CSZ-0-YY800-0700
800	1100	1,0	CSZ-0-YY810-0700
800	1200	1,0	CSZ-0-YY820-0700

Side Panel

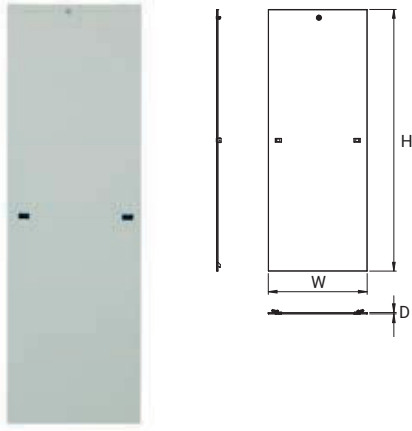

Material	1 mm Steel	Finish	Electrostatic Powder Paint	
Color	RAL 7035 (Light Grey) and RAL 9005 (Black)			
H (U)	W (mm)	D (mm)	H (mm)	Part No
16U	600	22	749	CSZ-X-16Y60-0501
22U	600	22	1016	CSZ-X-22Y60-0501
22U	800	22	1016	CSZ-X-22Y80-0501
26U	600	22	1194	CSZ-X-26Y60-0501
26U	800	22	1194	CSZ-X-26Y80-0501
26U	1000	22	1194	CSZ-X-26Y00-0501
32U	600	22	1460	CSZ-X-32Y60-0501
32U	800	22	1460	CSZ-X-32Y80-0501
36U	600	22	1638	CSZ-X-36Y60-0501
36U	800	22	1638	CSZ-X-36Y80-0501
36U	1000	22	1638	CSZ-X-36Y00-0501
36U	1200	22	1638	CSZ-X-36Y20-0501
39U	800	22	1772	CSZ-X-39Y80-0501
39U	1000	22	1772	CSZ-X-39Y00-0501
42U	600	22	1905	CSZ-X-42Y60-0501
42U	800	22	1905	CSZ-X-42Y80-0501
42U	1000	22	1905	CSZ-X-42Y00-0501
42U	1100	22	1905	CSZ-X-42Y10-0501
42U	1200	22	1905	CSZ-X-42Y20-0501
47U	600	22	2127	CSZ-X-47Y60-0501
47U	800	22	2127	CSZ-X-47Y80-0501
47U	1000	22	2127	CSZ-X-47Y00-0501
47U	1100	22	2127	CSZ-X-47Y10-0501
47U	1200	22	2127	CSZ-X-47Y20-0501

Rear Metal Solid Panel

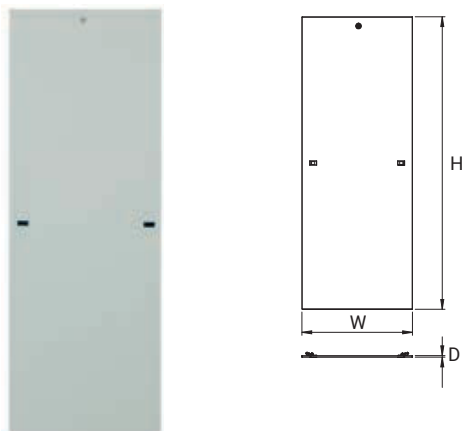

Material	1 mm Steel	Finish	Zinc-Plated		
H (U)	W (mm)	D (mm)	H (mm)	Weight kg	Part No
16U	600	23	752	5,1	CSZ-X-166Y0-0901
22U	600	23	1018	6,7	CSZ-X-226Y0-0901
22U	800	23	1018	8,8	CSZ-X-228Y0-0901
26U	600	23	1196	7,8	CSZ-X-266Y0-0901
26U	800	23	1196	10,2	CSZ-X-268Y0-0901
32U	600	23	1463	9,5	CSZ-X-326Y0-0901
32U	800	23	1463	12,3	CSZ-X-328Y0-0901
36U	600	23	1641	10,6	CSZ-X-366Y0-0901
36U	800	23	1641	13,8	CSZ-X-368Y0-0901
39U	800	23	1774	14,9	CSZ-X-398Y0-0901
42U	600	23	1907	12,2	CSZ-X-426Y0-0901
42U	800	23	1907	16,0	CSZ-X-428Y0-0901
47U	600	23	2130	13,6	CSZ-X-476Y0-0901
47U	800	23	2130	17,7	CSZ-X-478Y0-0901

X : Color code = 7: RAL 7035 (Grey); 9: RAL 9005 (Black)

Metal Solid Door

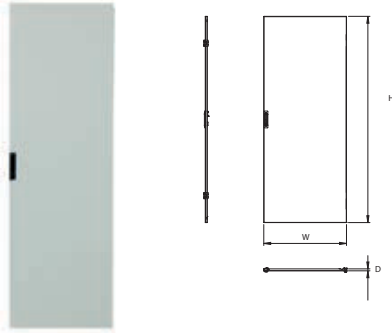

Glass Door

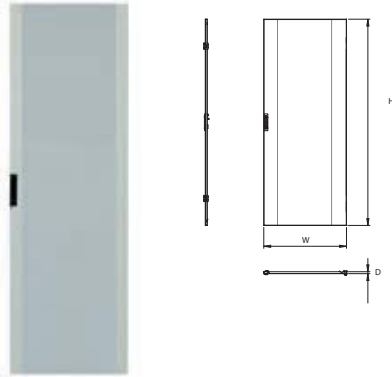

Perforated Flat Door

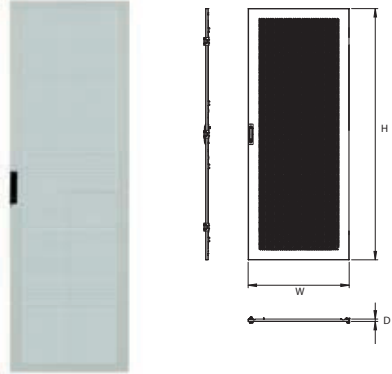

Double Perforated Door

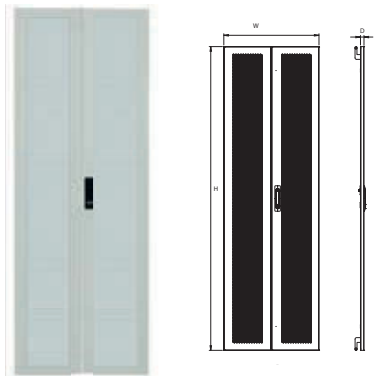

Material	1.2 mm Steel	Finish	Electrostatic Powder Paint		
Color	RAL 7035 (Light Grey) and RAL 9005 (Black)				
H (U)	W (mm)	D (mm)	H (mm)	Weight kg	Part No
16U	600	22	749	6,87	CSZ-X-166Y0-0902
22U	600	22	1016	8,94	CSZ-X-226Y0-0902
22U	800	22	1016	11,26	CSZ-X-228Y0-0902
26U	600	22	1194	10,32	CSZ-X-266Y0-0902
26U	800	22	1194	12,97	CSZ-X-268Y0-0902
32U	600	22	1460	12,39	CSZ-X-326Y0-0902
32U	800	22	1460	15,54	CSZ-X-328Y0-0902
36U	600	22	1638	13,77	CSZ-X-366Y0-0902
36U	800	22	1638	17,26	CSZ-X-368Y0-0902
39U	800	22	1772	18,54	CSZ-X-398Y0-0902
42U	600	22	1905	15,84	CSZ-X-426Y0-0902
42U	800	22	1905	19,83	CSZ-X-428Y0-0902
47U	600	22	2127	17,56	CSZ-X-476Y0-0902
47U	800	22	2127	21,97	CSZ-X-478Y0-0902

Material	1.2 mm Steel	Finish	Electrostatic Powder Paint		
Color	RAL 7035 (Light Grey) and RAL 9005 (Black)				
H (U)	W (mm)	D (mm)	H (mm)	Weight kg	Part No
16U	600	22	749	5,53	CSZ-X-166Y0-0903
22U	600	22	1016	7,42	CSZ-X-226Y0-0903
22U	800	22	1016	9,77	CSZ-X-228Y0-0903
26U	600	22	1194	8,68	CSZ-X-266Y0-0903
26U	800	22	1194	11,42	CSZ-X-268Y0-0903
32U	600	22	1460	10,56	CSZ-X-326Y0-0903
32U	800	22	1460	13,9	CSZ-X-328Y0-0903
36U	600	22	1638	11,82	CSZ-X-366Y0-0903
36U	800	22	1638	15,55	CSZ-X-368Y0-0903
39U	800	22	1772	16,79	CSZ-X-398Y0-0903
42U	600	22	1905	13,7	CSZ-X-426Y0-0903
42U	800	22	1905	18,02	CSZ-X-428Y0-0903
47U	600	22	2127	15,27	CSZ-X-476Y0-0903
47U	800	22	2127	20,09	CSZ-X-478Y0-0903

Material	1.2 mm Steel	Color	RAL 7035 (Light Grey) and RAL 9005 (Black)		
Finish	Electrostatic Powder Paint	Perforation Rate	65%		
H (U)	W (mm)	D (mm)	H (mm)	Weight kg	Part No
26U	600	22	1194	7,81	CSZ-X-266Y0-0904
36U	600	22	1638	10,15	CSZ-X-366Y0-0904
39U	800	22	1772	14,02	CSZ-X-398Y0-0904
42U	600	22	1905	11,80	CSZ-X-426Y0-0904
42U	800	22	1905	15,17	CSZ-X-428Y0-0904
47U	600	22	2127	12,97	CSZ-X-476Y0-0904
47U	800	22	2127	16,69	CSZ-X-478Y0-0904

Material	1.2 mm Steel	Color	RAL 7035 (Light Grey) and RAL 9005 (Black)		
Finish	Electrostatic Powder Paint	Perforation Rate	65%		
H (U)	W (mm)	D (mm)	H (mm)	Weight kg	Part No
26U	600	22	1194	11,99	CSZ-X-266Y0-0908
36U	600	22	1638	15,70	CSZ-X-366Y0-0908
39U	800	22	1772	21,19	CSZ-X-398Y0-0908
42U	600	22	1905	18,16	CSZ-X-426Y0-0908
42U	800	22	1905	22,83	CSZ-X-428Y0-0908
47U	600	22	2127	20,01	CSZ-X-476Y0-0908
47U	800	22	2127	25,16	CSZ-X-478Y0-0908

X : Color code = 7: RAL 7035 (Grey); 9: RAL 9005 (Black)

High Perforation Rated Flat Door

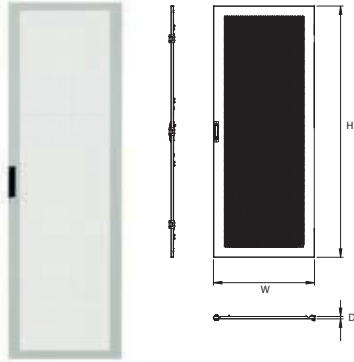

Material	1.2 mm Steel	Color	RAL 7035 (Light Grey) and RAL 9005 (Black)		
Finish	Electrostatic Powder Paint		Perforation Rate	80%	
H (U)	W (mm)	D (mm)	H (mm)	Weight kg	Part No
26U	600	22	1194	7,51	CSZ-X-266Y0-0909
36U	600	22	1638	9,85	CSZ-X-366Y0-0909
39U	800	22	1772	13,72	CSZ-X-398Y0-0909
42U	600	22	1905	11,50	CSZ-X-426Y0-0909
42U	800	22	1905	14,87	CSZ-X-428Y0-0909
47U	600	22	2127	12,67	CSZ-X-476Y0-0909
47U	800	22	2127	16,39	CSZ-X-478Y0-0909

High Perforation Rated Double Door



Material	1.2 mm Steel	Color	RAL 7035 (Light Grey) and RAL 9005 (Black)		
Finish	Electrostatic Powder Paint		Perforation Rate	80%	
H (U)	W (mm)	D (mm)	H (mm)	Weight kg	Part No
26U	600	22	1194	11,69	CSZ-X-266Y0-0911
36U	600	22	1638	15,40	CSZ-X-366Y0-0911
39U	800	22	1772	20,89	CSZ-X-398Y0-0911
42U	600	22	1905	17,86	CSZ-X-426Y0-0911
42U	800	22	1905	22,53	CSZ-X-428Y0-0911
47U	600	22	2127	19,71	CSZ-X-476Y0-0911
47U	800	22	2127	24,86	CSZ-X-478Y0-0911

Rear Metal Panel with Cable Entry



Material	1 mm Steel		Finish	Electrostatic Powder Paint	
Color	RAL 7035 (Light Grey) and RAL 9005 (Black)				
H (U)	W (mm)	D (mm)	H (mm)	Weight kg	Part No
3U	600	23	133	0,97	CSZ-X-036Y0-0915
3U	800	23	133	1,35	CSZ-X-038Y0-0915
4U	600	23	177	1,24	CSZ-X-046Y0-0915
4U	800	23	177	1,71	CSZ-X-048Y0-0915
5U	600	23	222	1,52	CSZ-X-056Y0-0915
5U	800	23	222	2,06	CSZ-X-058Y0-0915
6U	600	23	266	1,79	CSZ-X-066Y0-0915
6U	800	23	266	2,42	CSZ-X-068Y0-0915

Adjustable Cable Entry Panel with EPDM Gasket



Material	1 mm Steel		Finish	Electrostatic Powder Paint	
Color	RAL 7035 (Light Grey) and RAL 9005 (Black)				
W (mm)	D (mm)	H (mm)	Weight kg	Part No	
350	152	20	0,53	CSZ-X-YYYY0-0803	

X : Color code = 7: RAL 7035 (Grey); 9: RAL 9005 (Black)

Adjustable Feet

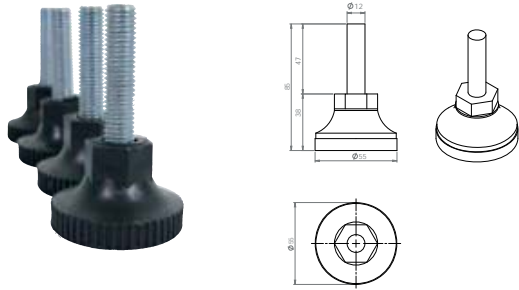

Material	Steel and Plastic ABS	Finish	Zinc Plated
Packaging	4 pieces in a box		

Maximum Static Load	Set Weight kg	Part No
600 kg / piece	0.35	CCA-0-7014

Multi Point Lock for Double Doors

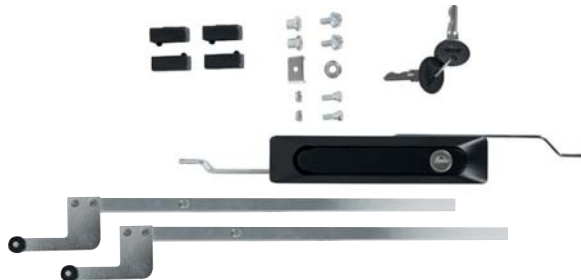

Material	Steel, Polyamide
Packaging	1 piece in a box
Part No	CSZ-0-YYYY0-1005

Four Point Lock for Single Perforated Door



Material	Steel, Polyamide
Packaging	1 piece in a box
Part No	CSZ-0-YYYY0-1004

Three Point Lock for Single Perforated Door



Material	Steel, Polyamide
Packaging	1 piece in a box
Part No	CSZ-0-YYYY0-1006

Castor Set

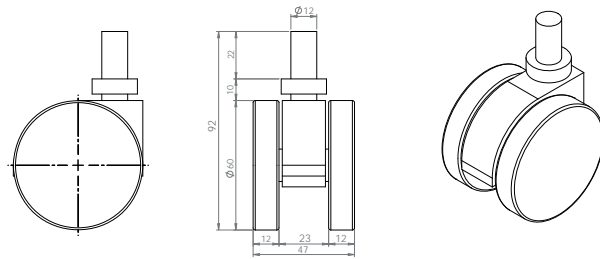

Material	Steel and Plastic ABS	Finish	Zinc Plated
Packaging	2 pcs with stopper and 2 pcs without Stopper in a box		

Single Point Lock



Maximum Static Load	Set Weight kg	Part No
75 kg / piece	0.77	CCA-0-7015

Material	Polyamide
Packaging	1 piece in a box
Part No	CPZ-0-YYYY0-1003

Cylindrical Lock for Side Panel



Material	Zamak, Steel
Packaging	1 piece in a box
Part No	CPZ-0-YYYY0-1001

Cylindrical Lock for Rear Metal Solid Panel



Material	Zamak, Steel
Packaging	1 piece in a box
Part No	CPZ-0-YYYY0-1002

Intelligent Rack

Technical Features

- H x W x D: 42U x 800mm x 1000mm
- Steel frame chassis according to 25mm DIN system
- 1200 kg carrying capacity
- Depth adjustable 19" mounting rails with U marking
- Front and rear doors with internal frame and 80% perforation ratio
- Electronic lock with keypad, integrated to EMMS System
- Side panels, top and bottom sheets are bolted internally
- Two-piece top sheet with adjustable cable entry
- Three-piece bottom sheet with adjustable cable entry
- Adjustable feet
- Earthing kit and earthing bar
- RAL 7035 powder coated

Accessories

- Four cable management panels with 5 cable guides
- 1U 19" blank panels
- Shielded cable channels for data and power cabling
- 3 pcs of radial fans with 625 m³/h for cooling (N+1 redundancy)
- Two temperature sensors at upper and lower part of the rack

Power Supply

- 230V and 400V (three phase) power feed
- Redundant power feed
- Cable connections according to DIN VDE 0113

